



AUTOMOTIVE TECHNOLOGY
optibelt MT-A II

Mounting tool
for OPTIBELT
elastic ribbed belts





AUTOMOTIVE TECHNOLOGY

optibelt **MT-A II**

THE RIGHT TOOL FOR THE JOB – WITH THE OPTIBELT MT-A II MOUNTING TOOL

It is essential that elastic V-ribbed belts are fitted to belt pulleys safely and without damaging them. Damaging or overstretching the sensitive tensile reinforcement must be prevented at all costs. The **optibelt MT-A II** mounting tool enables the generator belt to be

changed easily and professionally. The special tool for certain Ford and Volvo engines is needed since the belt slips off the water pump pulley when the **MT-A** tool is used. The **MT-A** tool is required for the second belt that drives either the servo pump or the air

conditioning compressor, depending on the vehicle.

The **MT-A II** comes in a sturdy plastic box with instructions for easy handling.

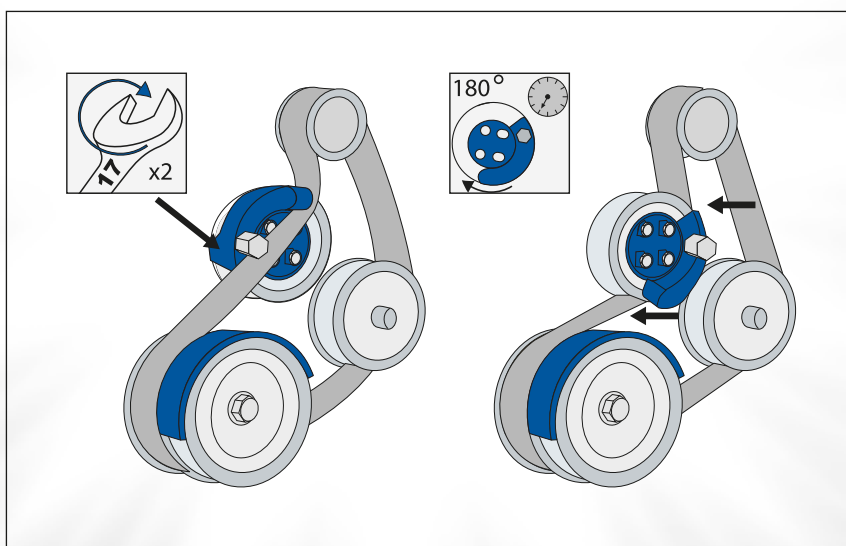
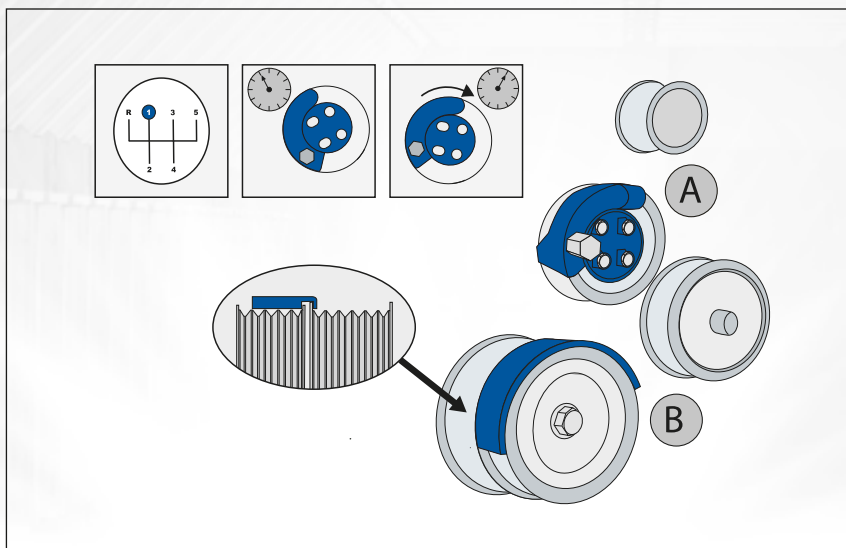

OPTIBELT
installation video at:
www.optibelt.com/mt-a-en

