

Technical Data Sheet

optibelt ALPHA LINEAR / V F2.5 - ST

PU Flat Belt, Optionally with Fabric PAZ,
Open-Ended / Endless Joined



Dimensions, Tolerances

Profile:	F2.5
Total thickness:	2.5 mm
Width tolerance:	±0.5 mm
Thickness tolerance:	±0.2 mm

Construction

Polyurethane:	Thermoplastic, 92 Shore A, white
Tension cord:	Steel, Ø 1.2 mm
Fabric, optional:	Polyamide, tooth side (PAZ), green

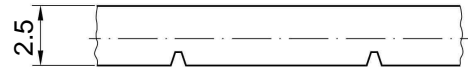

Cord tensile force, minimum belt length, belt weight

Belt width ¹ b [mm]	15	25	30	40	50	75	100
F_{Br} [N], ALPHA LINEAR	10360	19000	22480	32840	43240	67440	89960
F_{zul} [N] ² , ALPHA LINEAR, $\epsilon_{zul}=0.51\%$	2590	4750	5620	8210	10810	16860	22490
F_{zul} [N] ² , ALPHA V	1295	2375	2810	4105	5405	8430	11245
Minimum length ALPHA V [mm]	-	700	-	-	900	900	900
Weight per meter [kg/m]	0.086	0.143	0.171	0.228	0.285	0.428	0.570

¹ Smaller and intermediate widths possible ² Allowable tensile force $F_{zul} = 25\% / 12.5\%$ (ALPHA LINEAR / V) of cord breaking strength F_{Br} $C_{spez} = F_{zul} / \epsilon_{zul}$

Inside and outside idlers

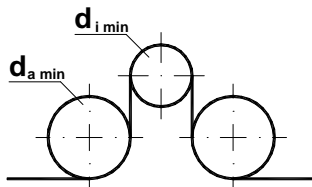

Minimum diameter of a plane inside idler: $d_{i \min} = 80 \text{ mm}$

Minimum diameter of a plane outside idler: $d_{a \min} = 120 \text{ mm}$